

Towong Table Lamp Dark Green / Oat

24597258 24597234

Thank you for purchasing the **Towong Table Lamp**. Before you begin to assemble your new lamp, please check to ensure that all hardware and parts have been supplied. This page lists all contents included in the carton(s).

Follow instructions closely as deviation from them may present a possible safety risk and may void your warranty.

It is recommended that assembly is done on a soft surface such as carpet to avoid any damage.

If you experience any problems with your new purchase. Please phone Freedom Customer Service (FCS) on 1300 135 588 (Australia) or 0800 469 327 (New Zealand).

Care Information

Periodically check and re-tighten all fasteners. Wipe down surfaces using a clean cloth weekly. If the external flexible cable or cord is damaged it needs to be replaced by a professional. Ensure screws are fastened firmly as small parts may present a choking hazard.

Replacing the bulb:

Disconnect the plug from the electrical supply and allow the bulb and lamp to cool down, replace the bulb with as **E14 Max. 40W**. Re-connect the supply and turn on.

Specifications:

220-240V ~.50Hz

IP20-Indoor Use only

E14 Max.40W  (bulb not included)

E14 Max.9W 

E14 Max.15W 

Class II protection

 **E14 Max. 40W**

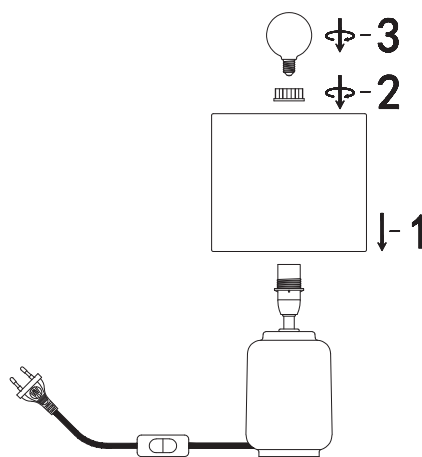

E14 Max.40W 
E14 Max.9W 
E14 Max.15W 